

OFFICE SPACE

8,500 - 17,000 SQUARE FEET

FOR LEASE



4275 NW Pacific Rim Boulevard | Camas, WA



[WEBSITE](#)

Mark Childs, SIOR

principal broker

503.542.4350

markc@capacitycommercial.com

Tamara J. Fuller

senior vice president

360.946.4832

tamara.fuller@capacitycommercial.com

Eric Anderson

vice president

360.946.4831

eric@capacitycommercial.com

SITE INFORMATION



SITE SPECS

&

INFORMATION

- >> Secured Second Story Full-Floor Office
- >> 8,500 - 17,000 SF
- >> Break Room with Kitchenette
- >> Elevator
- >> Dedicated Restrooms
- >> Ample Parking
- >> Open Floor Plan Lined with 36 Private Offices
- >> 3 Conference Rooms
- >> \$1.00 / SF Gross



[WEBSITE](#)

Mark Childs, SIOR

principal broker

503.542.4350

mark@capacitycommercial.com

Tamara J. Fuller

senior vice president

360.946.4832

tamara.fuller@capacitycommercial.com

Eric Anderson

vice president

360.946.4831

eric@capacitycommercial.com

PROXIMITY

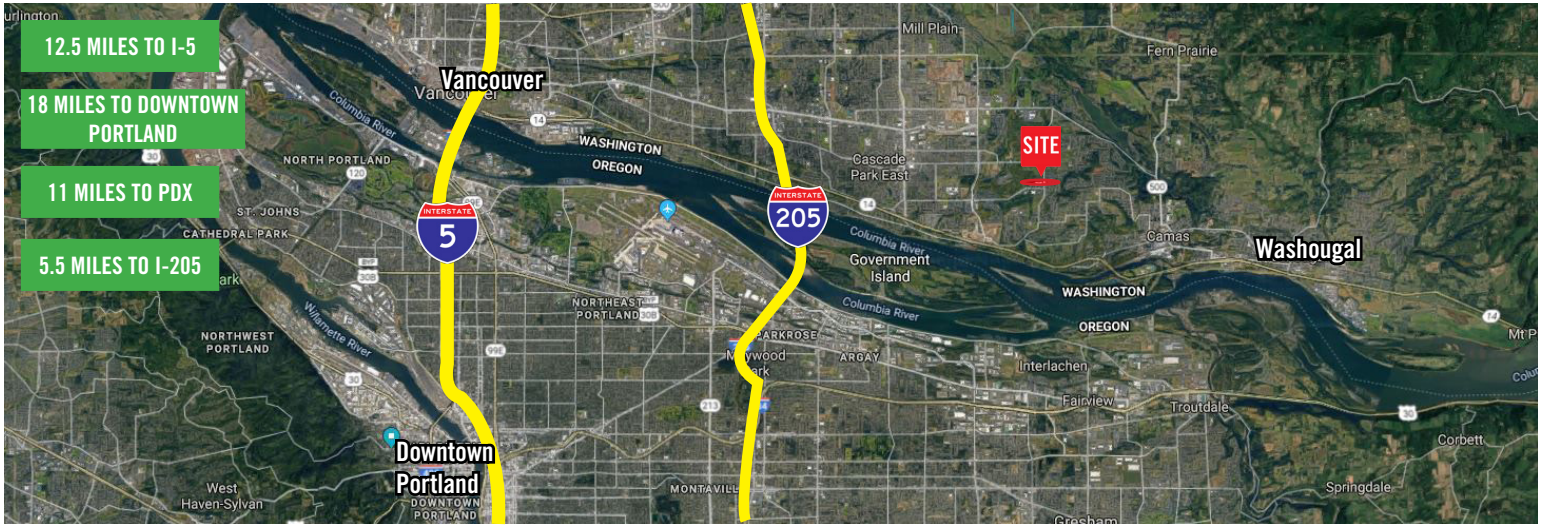

NEIGHBORS



[WEBSITE](#)

Mark Childs, SIOR

principal broker

503.542.4350

markc@capacitycommercial.com

Tamara J. Fuller

senior vice president

360.946.4832

tamara.fuller@capacitycommercial.com

Eric Anderson

vice president

360.946.4831

eric@capacitycommercial.com

SITE PLANS



FIRST & SECOND FLOOR OFFICE

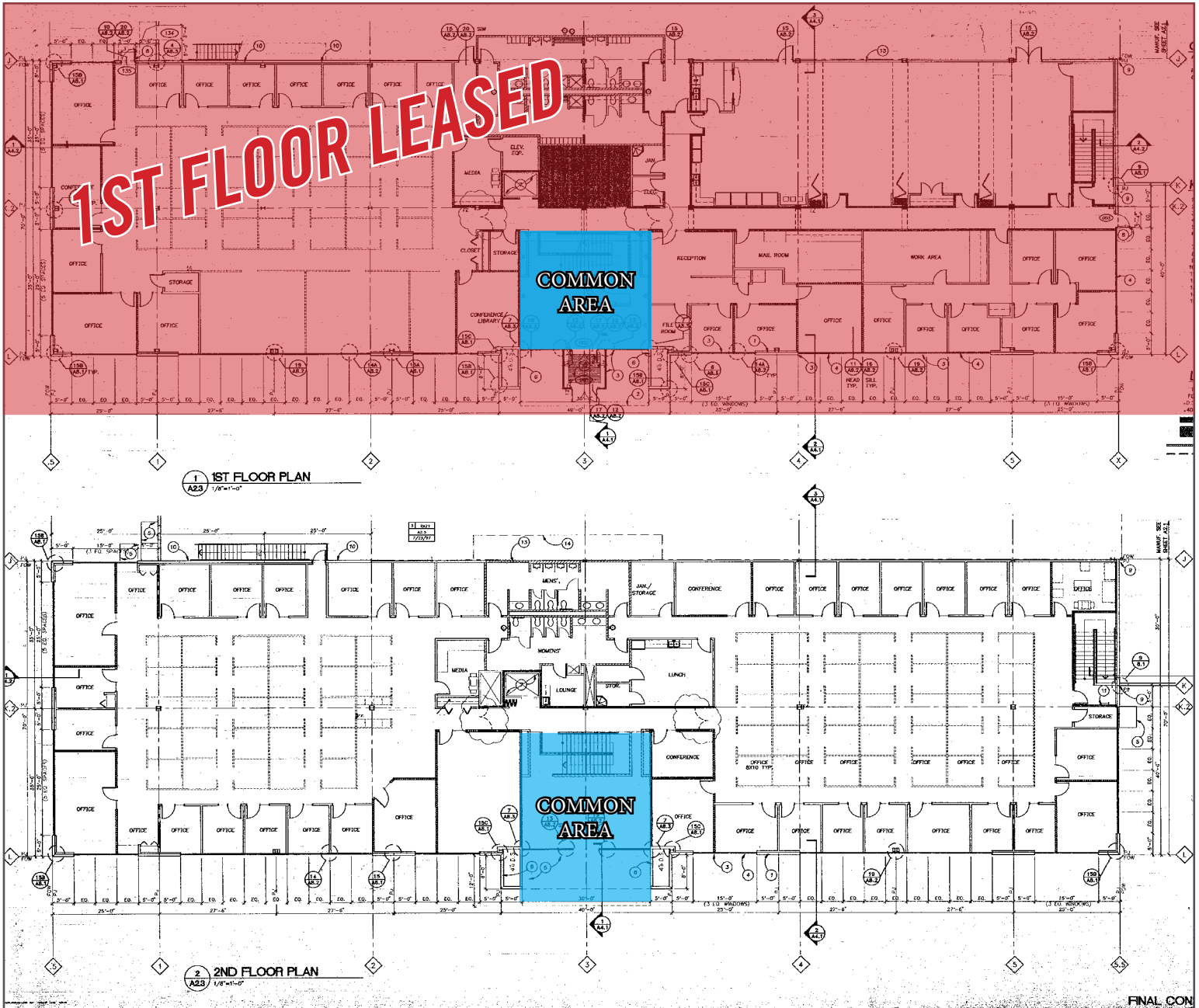

WEBSITE

Mark Childs, SIOR

principal broker

503.542.4350

mark@capacitycommercial.com

Tamara J. Fuller

senior vice president

360.946.4832

tamara.fuller@capacitycommercial.com

Eric Anderson

vice president

360.946.4831

eric@capacitycommercial.com

SITE PHOTOS



EMPLOYEE BREAKROOM



OPEN OFFICE PLAN



CONFERENCE ROOM



OPEN ENTRY



[WEBSITE](#)

Mark Childs, SIOR

principal broker

503.542.4350

markc@capacitycommercial.com

Tamara J. Fuller

senior vice president

360.946.4832

tamara.fuller@capacitycommercial.com

Eric Anderson

vice president

360.946.4831

eric@capacitycommercial.com